



**INSTRUCTION MANUAL
FOR MAGAZINE FED
SEMI-AUTOMATIC SHOTGUN**

ⓘ READ THE INSTRUCTIONS AND ⓘ
WARNINGS IN THIS MANUAL CAREFULLY
BEFORE USING THIS FIREARM ⓘ

INTRODUCTION

Thank you for purchasing the BALIKLI shotgun. We are sure this gun will bring you years of hunting or shooting pleasure.

This manual provides important information for assembling and using your new gun. Please read your Owner's Manual carefully before handling the gun.

Follow safe gun handling procedure at all times. Get instructions from a competent firearms instructor before using the firearm.

If you have questions or concerns about the assembly or the operation of your gun, see your dealer, or a qualified gunsmith.

Keep this manual, and consult it as needed. If you sell or transfer your gun, make sure the manual stays with the gun.

This shotgun, which is produced with the latest possibilities of the contemporary technology, is reliable and practical about its aesthetics, its lightness, its operating system and its expertise in service.

OPERATION

This magazine fed semi-automatic shotgun uses gas pressure from the discharged shell in a precision, spring-loaded mechanism to eject the empty shell, and load a new cartridge into the chamber. The system reduces recoil, and permits the shooter to concentrate on the target.

This shotgun is produced in the high standards of technology and craftsmanship. The instruction in this book will help to assure that it delivers the fine performance for which it was designed.

SAFETY RULES

1. NEVER POINT A FIREARM AT SOMETHING THAT IS NOT SAFE TO SHOOT. Never let the muzzle of a firearm point at any part of your body or at another person. This is especially important when loading or unloading the firearm. When you are shooting at a target, know what is behind it. If you miss your target or if the bullet penetrates the target, it is your responsibility to ensure that the shot does not cause unintended injury or damage.

2. ALWAYS TREAT A FIREARM AS IF IT WERE LOADED. Never assume that a firearm is unloaded. The only certain way to ensure that a firearm is empty is to open the chamber and visually examine the inside to see if a round is present. Removing the magazine will not guarantee that a firearm is unloaded or cannot fire. Shotguns and rifles can be checked by cycling or removing all rounds and by then opening the chamber so that a visual inspection of the chamber for any remaining rounds can be made.

3. STORE YOUR FIREARM SO THAT CHILDREN CANNOT GAIN ACCESS TO IT. It is your responsibility to insure that children under the age of 18 or other unauthorized person does not gain access to your firearm. To reduce the risk of accidents involving children, unload your firearm, lock it and store the ammunition in a separate locked location. Please note that devices intended to prevent accidents - for example, cable locks, chamber plugs, etc, - may not prevent use or misuse of your firearm by a determined person. Steel gun safes may be more appropriate to reduce the likelihood of intentional misuse of a firearm by an unauthorized child or person.

4. NEVER SHOOT AT WATER OR AT A HARD SURFACE. Shooting at the surface of water or at a rock or other hard surface increases the chance of ricochets or fragmentation of the bullet or shot, which can result in the projectile striking an unintended or peripheral target.

5. KNOW THE SAFETY FEATURES OF THE FIREARM YOU ARE USING, BUT REMEMBER: SAFETY DEVICES ARE NOT A SUBSTITUTE FOR SAFE HANDLING PROCEDURES.

Never rely solely on a safety device to prevent an accident. It is imperative that you know and use the safety features of the particular firearm you are handling, but accidents can best be prevented by following the safe handling procedures described in these safety rules and elsewhere in the product manual. To further familiarize yourself with the proper use of this or other firearms, take a Firearms Safety Course taught by an expert in firearm use and safety procedures.

6. PROPERLY MAINTAIN YOUR FIREARM. Store and carry your firearm so that dirt or lint does not accumulate in the working parts. Clean and oil your firearm, following the instructions provided in this manual, after each use to prevent corrosion, damage to the barrel or accumulation of impurities which can prevent use of the gun in an emergency. Always check the barrel prior to loading to ensure that it is clean and free from obstructions. Firing against an obstruction can rupture the barrel and injure you or others nearby. In case you hear an unusual noise when shooting, stop firing immediately, engage the manual safety and unload the firearm. Make sure the chamber is free from any obstruction inside the barrel due to defective or improper ammunition.

7. USE PROPER AMMUNITION. Only use factory-loaded, new ammunition manufactured to industry specifications: CIP (Europe and elsewhere), SAAMI (U.S.A.). Be certain that each round you use is in the proper caliber or gauge and type for the particular firearm. The caliber or gauge of the firearm is clearly marked on the barrels of shotguns. The use of reloaded or remanufactured ammunition can increase the likelihood of excessive cartridge pressures, case-head ruptures or other defects in the ammunition that can cause damage to your firearm and injury to yourself or others nearby.

8. ALWAYS WEAR PROTECTIVE GLASSES AND EARPLUGS WHEN SHOOTING. The chance that gas, gunpowder or metal fragments will blow back and injure a shooter who is firing a gun is rare, but the injury that can be sustained in such circumstances is severe, including the possible loss of eyesight. A shooter must always wear impact resistant shooting glasses when firing any firearm. Earplugs help reduce the chance of hearing damage from shooting.

9. NEVER CLIMB A TREE, FENCE OR OBSTRUCTION WITH A LOADED FIREARM. Open and empty the chamber of your firearm before climbing or descending a tree or before climbing a fence or jumping over a ditch or obstruction. Never pull or push a loaded firearm toward yourself or another person.

10. AVOID ALCOHOLIC BEVERAGES OR JUDGMENT OR REFLEX IMPAIRING MEDICATION WHEN SHOOTING. Do not drink and shoot. If you take medication that can impair motor reactions or judgment, do not handle a firearm while you are under the influence of the medication.

11. NEVER TRANSPORT A LOADED FIREARM. Unload a firearm before putting it in a vehicle. Hunters and target shooters should load their firearm only at their destination. If you carry a firearm for self-protection, leaving the chamber unloaded can reduce the chance of accidental discharge.

12. LEAD WARNING. Discharging firearms in poorly ventilated areas, cleaning firearms, or handling ammunition may result in exposure to lead and other substances known to cause birth defects, reproductive harm, and other serious physical injury. Have adequate ventilation at all times. Wash hands thoroughly after exposure.

AMMUNITION

USE ONLY SUITABLE AMMUNITION

This gas-operated, magazine fed semi-automatic shotgun is chambered for 3 inch magnum shells. It is designed to be used with factory-loaded shells between 2 ¼ " and 3" in length. For 12 Gauge use the cartridges between 28 gr. (1 oz.) and 52 gr. (1 ⅞ oz.)

Use of re-loaded ammunition voids the factory warranty.

WARNING: Do not use 3 ½ inch shells in this shotgun.

WARNING: Never shoot slugs with a full choke. Use cylinder choke (5) and improved cylinder choke (4), which are marked with five cuts and four cuts.

WARNING: Never use cartridges with a case longer than the chamber, as this would have serious consequences for both the gun and the shooter.

WARNING: Never shoot steel shot with a full choke. Use only modified, improved cylinder or cylinder choke tubes, marked three, four and five notches respectively.

NOTE: Always use ammunition that is powerful enough to fully cycle the action.

LOADING

1. First, point the shotgun in a safe direction. Remember, a safe direction means that the gun is pointed so that even if it were to go off, it would not cause injury, damage, or death. Always perform a safety check to make sure that the chamber is empty.

2. When the magazine is empty, the bolt catch lever holds the bolt open at the rear. Press the magazine release to remove the empty magazine and insert a loaded magazine. Remember to only use ammunition that is recommended by the manufacturer.
3. Push down the bolt catch lever with the thumb of the shooting hand and this will allow the bolt to move forward and chamber a round.

THE GUN IS NOW LOADED AND READY TO FIRE!

WARNING: Always unload your firearm immediately after shooting.

UNLOADING

1. Point the shotgun in a safe direction. Remember, a safe direction means that the gun is pointed so that even if it were to go off, it would not cause injury, damage, or death.
2. Keep your fingers off the trigger and remove the magazine.
3. Pull back the charging handle one or more times to insure the chamber is empty. Watch for a live round or empty case to be ejected. Pull the charging handle fully rearward and lock the bolt with the bolt catch lever.
4. Make sure the last round in the chamber has been extracted and ejected. Visually and physically check the chamber and the magazine well to make sure the shotgun has been fully unloaded.

DISASSEMBLY INSTRUCTIONS

MANUFACTURERS WARNING: This manufactured firearm was designed to perform with its original parts. It is your responsibility to make sure that any parts you buy are authentic and correctly installed and that the parts have not been altered. It is imperative that only factory parts be used as replacements to assure that the firearm remains functionally safe and operates accurately. The gun owner accepts full responsibility for the correct disassembly, replacement of parts and functioning of the firearm.

IMPORTANT WARNING: Before you begin any disassembly always;

- 1- Point the shotgun in a safe direction ,
- 2- Be sure that you remove the magazine from the firearm ,
- 3- Visually and manually inspect the chamber to confirm that it is empty.

DISASSEMBLY



1. Unscrew the front handguard secure cap and remove it.
2. Pull the handguard forward to remove it from the body.
3. Remove the barrel fixing nut, but you don't need to remove gas regulator nut and spring.

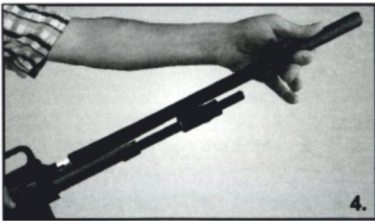

4. Pull the bolt to the rear slightly and remove the barrel as you are letting the bolt slide forward. Slowly release the bolt recoil spring/bolt carrier as the barrel comes out.

5. Turn the ratchet downward to release the carrier.

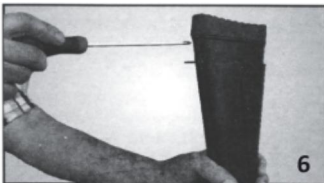

6. Remove the buttstock using a screwdriver to access the upper receiver retention bolt in the void of the buttstock.



7. Insert Allen socket into upper receiver retention bolt and loosen the bolt 4 full turns. Remove the ratchet and lightly tap the extension and socket to push the retention bolt forward (7a).

After the upper receiver starts to separate, loosen the bolt 2 to 3 more turns. Gently tap the extension to further separate the upper receiver from the buttstock. You will note an expanding gap as you do this (7b). When the widening of the gap is around 1 inch, you can remove the upper receiver retention bolt and washer.

Slightly compress and hold the recoil spring on the operational rod with one hand; this keeps the bolt from pushing forward and damaging the feed ramp. Use your other hand to help separate the upper receiver from the buttstock/lower receiver. As the upper receiver separates, lift the receiver up and off. This allows the bolt to clear the feed ramp on the lower receiver.

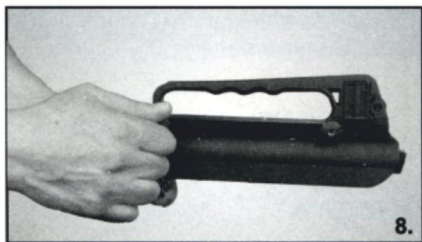

8. Further disassembly is not required for regular cleaning and maintenance.

CHOKE SET





The shotgun generally comes with 3 screw-in internal chokes (full, modified and cylinder bore). Each choke can be identified by the number of notches on it (full-1 notch, modified-3 notches, cylinder bore-5 notches).

A choke wrench is supplied in the box with the chokes. Before you attempt to install a choke always perform a safety check to make sure that the shotgun is unloaded and pointed in a safe direction. To install the choke you can insert it into the end of the barrel and hand screw it. It can then be tightened with the choke wrench to secure it in place.

SCREW-IN CHOKE WARNING

Never peer directly into the shotgun muzzle or change chokes when the gun is loaded regardless of the position of the safety. Never fire the shotgun if the screw-in choke is not fully and tightly bottomed to the barrel threads, or improperly installed or cross-threaded, or if the threads of the barrel or choke insert is damaged. In this situation the barrel will be damaged and the choke insert will be propelled out of the muzzle with high velocity which can result in death, serious injury, or property damage. Never fire the shotgun without the screw-in choke in place as it will cause an unpredictable shot pattern and damage the choke threads in the barrel thus making correct installation of the screw-in choke impossible without expansive re-barrelling.

CHOKE VALUES FOR SEMI - AUTOMATIC SHOTGUNS

CHOKE VALUE	SYMBOL	NUMBER OF NOTCHES
* FULL		1
** IMPROVED MODIFIED		2
*** MODIFIED		3
**** IMPROVED CYLINDER		4
***** CYLINDER		5

Do not use choke values FULL, IMPROVED MODIFIED, and MODIFIED with slugs, single bullets or single projectiles.

Do not use choke value FULL or IMPROVED MODIFIED with steel shot.

MAINTENANCE

Proper maintenance is important to assure the best functioning of the gun, and the safety of the shooter.

Before using the shotgun make sure the barrel is clean and free of any grease or obstruction.

WARNING: Before you start cleaning your shotgun always make sure it is unloaded and pointed in a safe direction. You are responsible for the proper care and maintenance of your shotgun.

CLEANING AND LUBRICATION

Materials and equipment necessary for cleaning and lubrication;

- Cleaning rod
- Cotton bore patches
- Brass bore brush
- Powder solvent
- Small soft brush
- Good quality shotgun oil

After each shooting session, dismantle the barrel, the barrel choke and the bolt for cleaning and lubrication, reinstall them as instructed.

After use, to remove any powder and lead residue in the bore, scrub the barrel and chamber using the bore brush with powder solvent. Then swab the bore and the chamber with shotgun oiled cotton patches to protect from rust and corrosion.

After a high number of shots (about 500 shots), disassemble the bolt assembly and clean it with a soft brush and shotgun oil. Then dry it carefully with a soft cloth and oil the parts lightly.

Clean the mechanism rod with a shotgun oiled soft cloth and then dry it with a soft cloth and oil the parts lightly.

Any powder on the chamber, barrel, etc. can be cleaned with a brush and powder solvent.

All external surfaces should be wiped down with light coat of rust preventative.

Avoid using too much solvent for bore cleaning, since prolonged contact may damage the finish of the shotgun. Make sure to wipe away all the excess solvent and lubricant.

STORAGE

Clean thoroughly and oil your gun before storage. Store the gun in a case to prevent scratches and dents. Store your firearm in a dry place to prevent corrosion.

Store the gun away from children and in a place where it cannot be obtained by those unauthorized to use it. Always store gun unloaded and separately from any ammunition.

HAZARDOUS MATERIAL WARNING

Discharging firearms in poorly ventilated areas, cleaning firearms, or handling ammunition, may result in exposure to lead and other substances known to cause birth defects, reproductive harm, and other serious injury. Have adequate ventilation at all times. Wash hands thoroughly after exposure.

GENERAL ASSEMBLY

<u>NO</u>	<u>PART NAME</u>	<u>NO</u>	<u>PART NAME</u>
1.	Choke	13.	Bolt Handle
2.	Front Sight	14.	Operational Rod
3.	Barrel	15.	Front Sling Ring
4.	Handguard	16.	Operational Spring
5.	Carrying Handle / Rear Sight	17.	Gas Piston
6.	Upper Receiver	18.	Bolt Carrier Spring
7.	Buttpad Screws	19.	Barrel Fixing Nut
8.	Buttpad	20.	Handguard Secure Cap
9.	Rear Sling Ring	21.	Upper Receiver Retention Bolt
10.	Lower Receiver & Stock	22.	Magazine (2 Included)
11.	Bolt Carrier	23.	Lower Receiver Telescopic Stock
12.	Bolt		

PARTS DIAGRAM

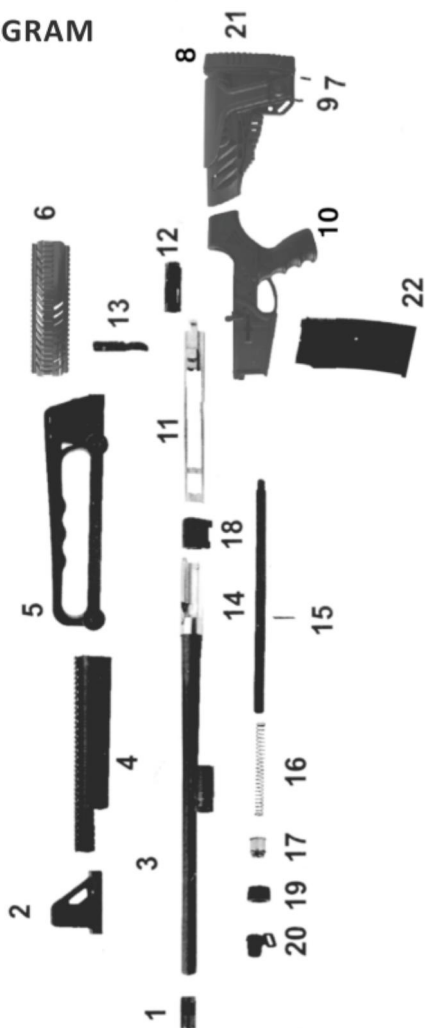

WARRANTY DEED

This product is covered by a 2-year guarantee by BALIKLI ARMS against faulty workmanship and manufacturing defects and BALIKLI ARMS agrees to supply free replacement parts (wood not included) for defected parts from date of purchase.

DISCLAIMER OF THE WARRANTY

- * Occurrence of damages due to firing with hand-filled or refilled cartridges
- * Occurrence of damages due to firing in case of blockage in the barrel
- * Occurrence of damages due to the lack of regular and necessary maintenance
- * Repairs and replacements made by unauthorized persons on guns are make warranty invalid.

Please note that certificates that are not sealed by the vendor or that are incomplete are invalid. By purchasing the product, the user acknowledges and agrees the foregoing.

- To be filled by the vendor -

Model /Calibre :

Serial No. :

Buyer's Name and Surname:

Sales Invoice No. :

Date of Sale :

[Vendor's seal and signature]



Üzümlü Mah. Köküstü Küme Evleri No. 12



Tel. +90 332 524 6 524 - 524 68 03



www.baliklisilah.com



Instagram

[instagram.com/balikli_arms_tactical](https://www.instagram.com/balikli_arms_tactical)



[facebook.com/Balikli Silah](https://facebook.com/BalikliSilah)

BEYŞEHİR / KONYA

Fax. +90 332 524 68 01



info@baliklisilah.com



export@baliklisilah.com

Contact +90 530 099 32 93